

THIS DRAWING INDICATES ALL PROPOSED OUTDOOR LIGHTING FIXTURES FOR THIS PROPOSED DEVELOPMENT. THE LIGHTING DESIGN IS IN ACCORDANCE WITH THE APPLICABLE LIGHTING ZONE AS ESTABLISHED BY THE PLANNING DEPARTMENT, AND DESIGNED WITH AN AVERAGE TO MINIMUM RATIO IN ACCORDANCE WITH THE ILLUMINATING ENGINEERING SOCIETY GUIDELINES. THIS LIGHTING DESIGN WILL NOT CREATE ANY OBJECTIONABLE GLARE FOR ADJACENT PROPERTIES.

CONTRACTOR TO BE RESPONSIBLE FOR LOCATION OF ALL EXISTING UNDERGROUND & OVERHEAD UTILITIES. VARIOUS UTILITIES CONCERNED TO BE GIVEN REQUIRED ADVANCE NOTICE PRIOR TO ANY DIGGING, FOR STAKE OUT. THE CONSULTANT ASSUMES NO RESPONSIBILITY FOR THE ACCURACY OF THE LOCATION OF EXISTING UTILITIES AS INDICATED ON THIS DRAWING.

NOTE: PHOTOMETRIC VALUES ARE SHOWN IN FOOT CANDLES WITH ISOMETRIC LIGHT CURVES

NOTE: ALL LIGHT FIXTURES ARE TO BE DOWNWARD DEFLECTED AND FULL CUT-OFF (NIGHT SKY COMPLIANT)

NOTE: FINAL LOCATIONS OF WALL MOUNTED SHOP LIGHTING TO BE APPROVED BY ARCHITECT AND OWNER PRIOR TO COMMENCEMENT OF WORK. TYPICAL

NOTE: CONTRACTOR TO REVIEW LIGHT FIXTURE SHOP DRAWINGS WITH CLIENT AND ENGINEER PRIOR TO COMMENCEMENT OF WORK FOR FINAL APPROVAL.

SITE LIGHTING NOTES:

- ALL NEW OUTSIDE LIGHTS TO BE CONTROLLED BY BUILDING PHOTOCELL AT HIGH LEVEL AND TIME SWITCH. COORDINATE CONTROLS AND POWER REQUIREMENTS WITH BUILDING DISTRIBUTION DRAWINGS.
- ALL PHOTOMETRIC VALUES ARE SHOWN IN FOOT CANDLES.

LEGEND

	CANOPY LIGHTS
	POLE LIGHTS
	WALL LIGHTS
	PHOTOMETRIC VALUES (SHOWN IN FOOT CANDLES)
	ISOMETRIC LIGHT CURVES

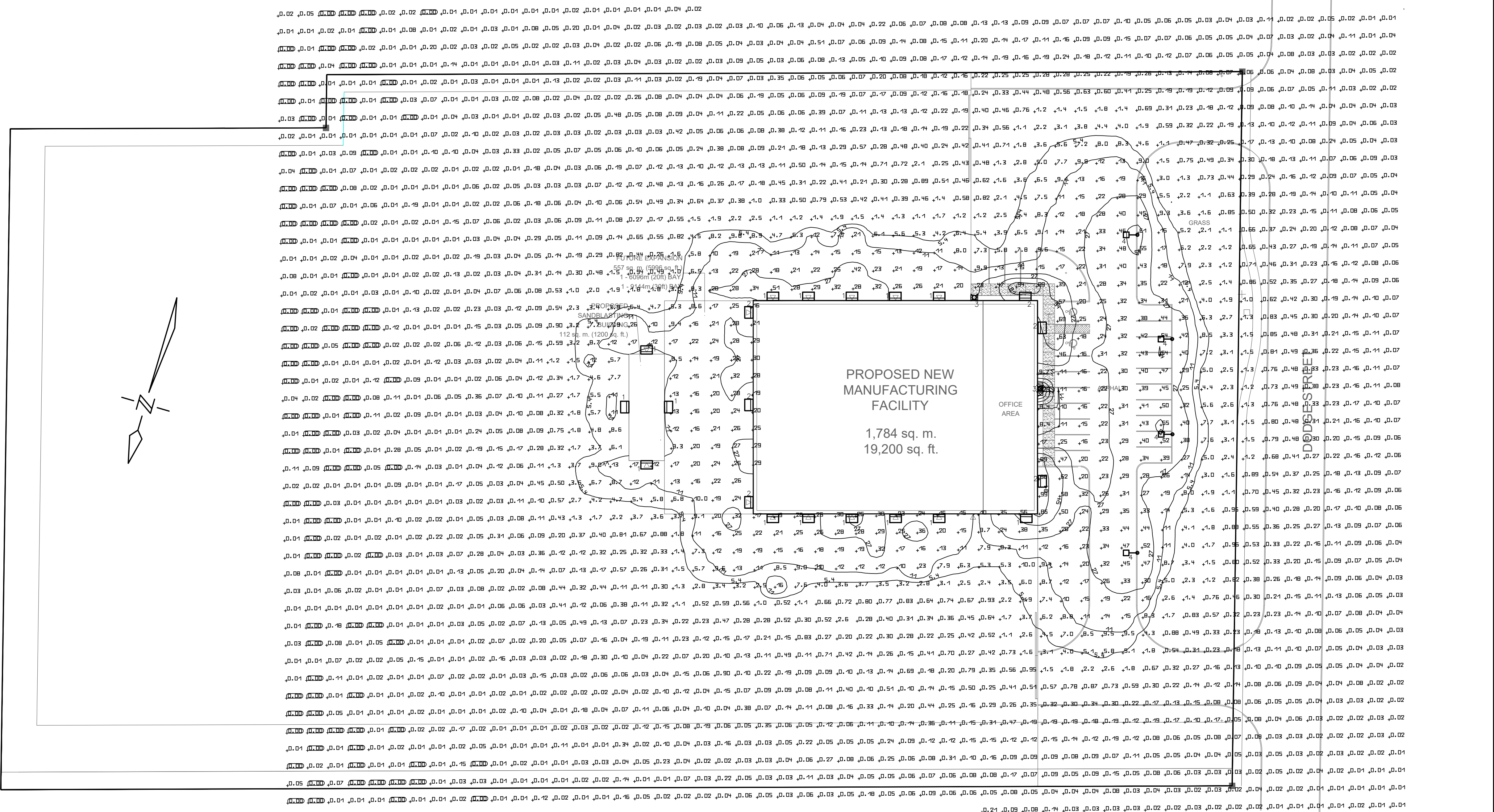
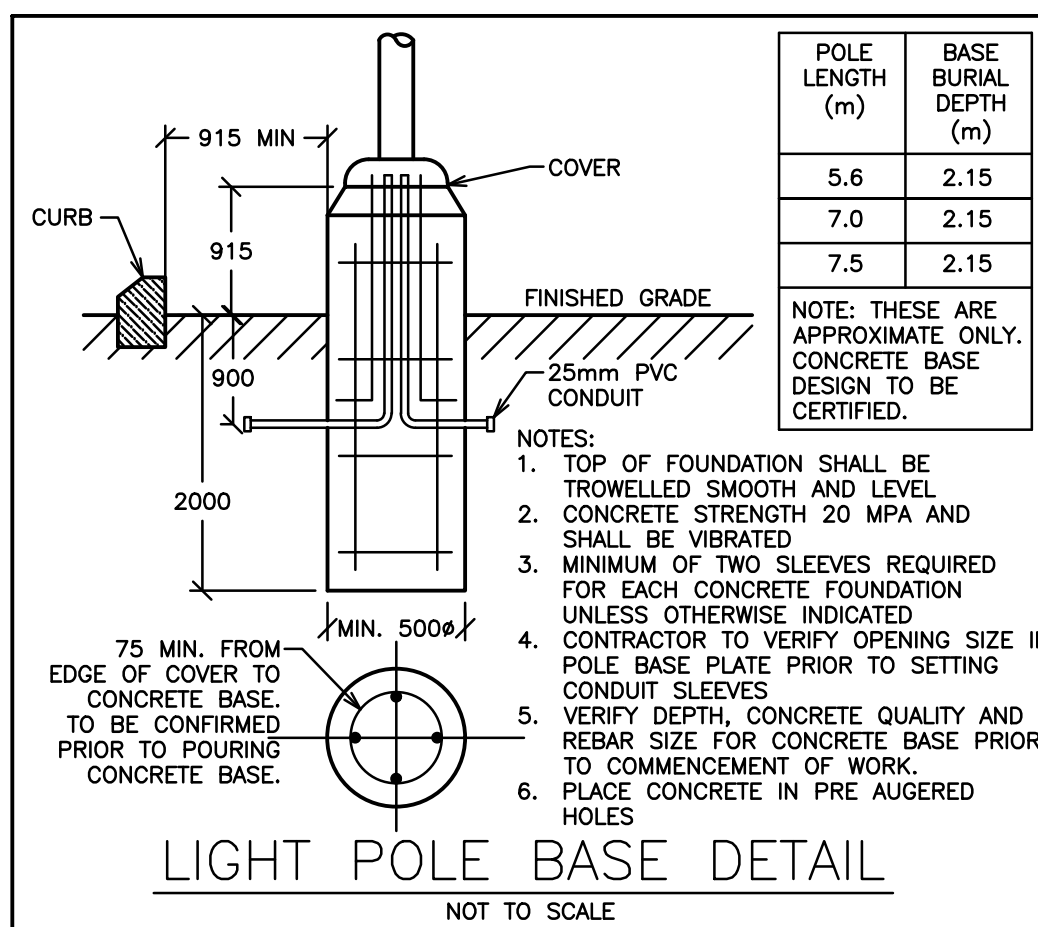

Luminaire list (Site 1)

Index	Manufacturer	Article name	Item number	Fitting	Luminous flux	Light loss factor	Connected load	Quantity
1	PHILIPS STONCO	LytaPro 16 LED Small Wall Sconce	LPW16-7	1x16 NW Lumiled Luxeon R LEDS	3373 lm	0.80	36.3 W	15
2	PHILIPS STONCO/KEENE	LytaPro 32 LED Medium Wall Sconce CAST GRAY ENAMEL ALUMINUM AND PLASTIC HOUSING, CLEAR GLASS ENCLOSURE	LPW32-7	1x32 WHITE LEDS WITH CLEAR PLASTIC OPTICS BELOW EACH	6911 lm	0.80	70.5 W	6
3	Aculux	3" ROUND 800 LUMEN 12 DEGREE OPTIC LED HOUSING WITH DOWNLIGHT LENSED PINHOLE TRIM	AK3-18-04 DBLM 30K 800R 12D E21 MVOLT + 30PIN BS WET	1xLED	437 lm	0.80	7 W	2
4	SIGNIFY GARDCO	EcoForm Area LED ECF - Small, 48 LED's, 4000K CCT 0-NW-G2-4	ECF-S-48L-90 0-NW-G2-4	1x(3) LEDS/36 SLD LIGHT ARRAY(S) DRIVEN AT 800mA	16794 lm	0.80	135.1 W	4

NUMERIC SUMMARY

#	Name	Parameter	Min	Max	Average	Min/average	Min/max
1	SIDE DOOR	Perpendicular Illuminance	25.5 lx	49.4 lx	30.4 lx	0.84	0.52
2	FRONT DOOR	Perpendicular Illuminance	12.2 lx	329 lx	94.8 lx	0.13	0.037
3	PARKING LOT	Perpendicular Illuminance	2.44 lx	88.4 lx	29.5 lx	0.083	0.028

#	Name	Parameter	Min	Max	Average	Min/average	Min/max
1	ENTIRE LOT	Perpendicular Illuminance	0.000 fc	12.0 fc	0.38 fc	0.000	0.000

NO.	REVISION	DATE	BY	APPROVED
3	RE-ISSUED FOR SPA	NOV 29	A.P	G.V.W.O
2	RE-ISSUED FOR SPA	NOV 25	A.P	G.V.W.O
1	ISSUED FOR SPA	NOV 14	A.P	G.V.W.O

DODGE ST, COBOURG, ONTARIO
DALREN LIMITED

SITE LIGHTING
LOADSTAR TRAILERS

D.G. Biddle & Associates Limited
consulting engineers and planners
96 KING STREET EAST • OSHAWA, ON L1H 1B6
PHONE (905) 576-8500 FAX (905) 576-9730
INFO@DGBIDDLE.COM

SCALE:	1/400	PROJECT NO:	119772
DRAWN BY:	A.P	DRAWING NO:	SL
DESIGN BY:	A.P	CAD FILE:	119772_SL
CHECKED BY:	G.V.W.O	PLOT DATE:	28/11/2019
DATE:	NOV. 2019	SUBMISSION:	SPA