



COBOURG COMMUNITY CENTRE

RENTAL INFORMATION

For more information contact:

T: 905-372-7371

E: cccinfo@cobourg.ca

750 D'Arcy Street
Cobourg, ON K9A 0G1
ccc.cobourg.ca

COBOURG COMMUNITY CENTRE

Business Meetings, Arts Performances and Athletic Tournaments will all find Cobourg a great place for any event.



MAIN FLOOR PLAN

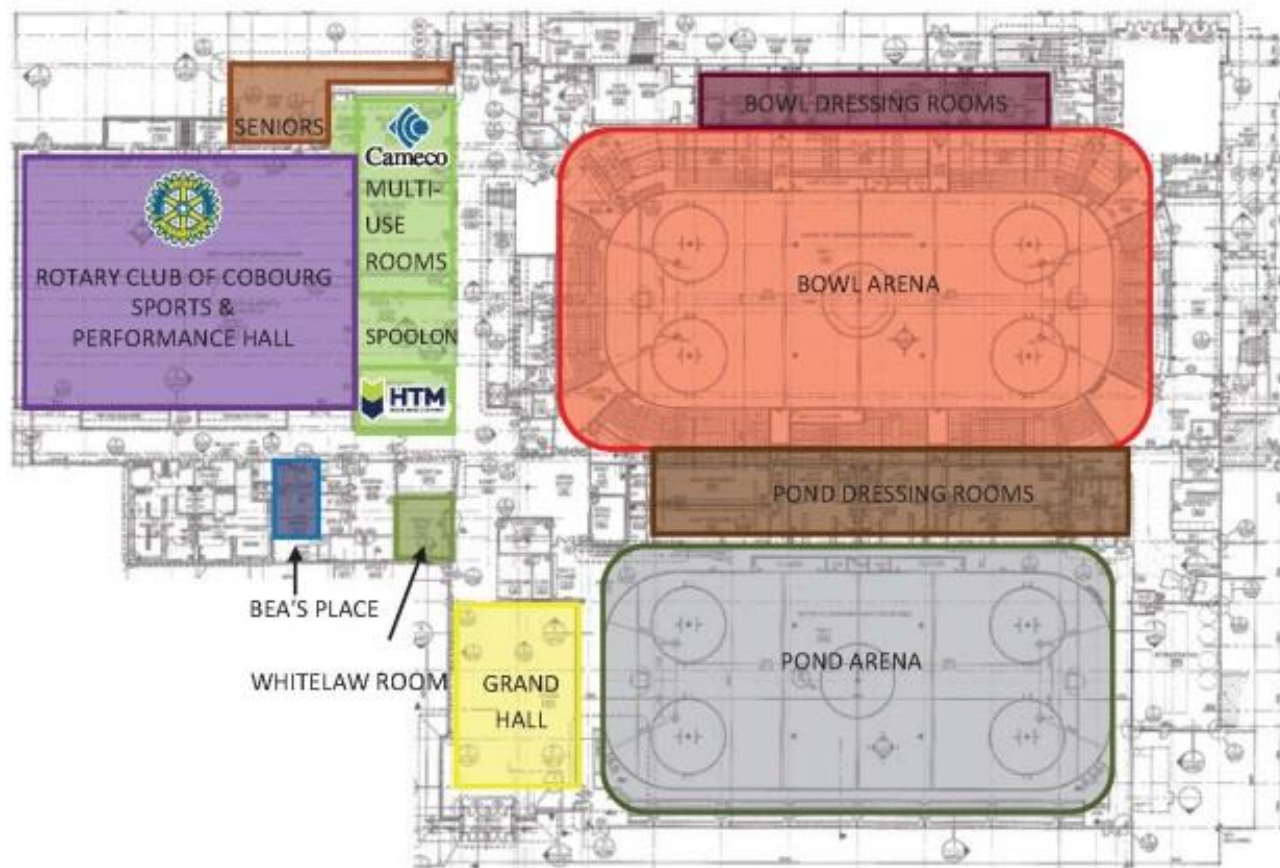

- | | | | |
|---------------------------------------------------------------------------------------------------|---------------------------------------------------------------------------------------------------------|---------------------------------------------------------------------------------------------------|---------------------------------------------------------------------------------------------------------------|
|  GRAND HALL |  POND ARENA |  BEA'S PLACE |  BOWL DRESSING ROOMS (4) |
|  SENIORS CENTRE |  GYM |  WHITELAW ROOM |  POND DRESSING ROOMS (6) |
|  BOWL ARENA |  MULTI-USE ROOMS (5) | | |

SECOND STOREY PLAN

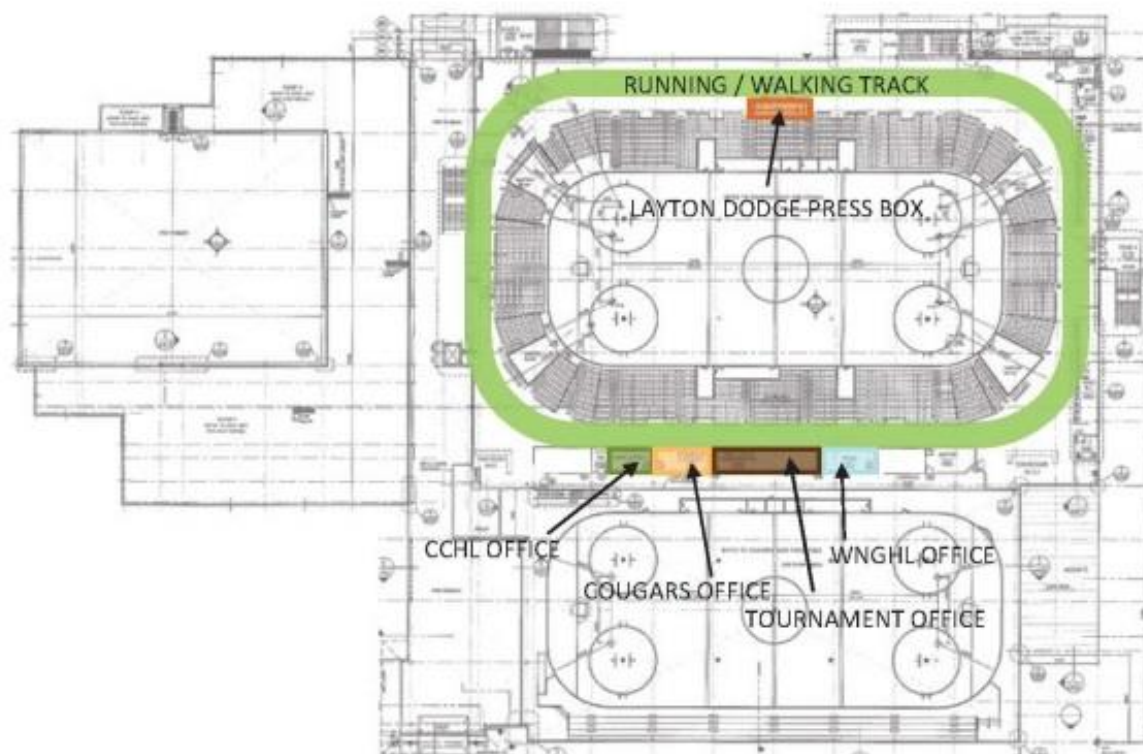

- | | | |
|-------------------------------------------------------------------------------------------------------------|--------------------------------------------------------------------------------------------------------|------------------------------------------------------------------------------------------------------------------------------------|
|  LAYTON DODGE PRESS BOX |  CCHL HOCKEY OFFICE |  TOURNAMENT OFFICE |
|  RUNNING / WALKING TRACK |  COUGARS OFFICE |  WEST NORTHUMBERLAND GIRLS HOCKEY LEAGUE OFFICE |

BOWL ARENA

The Bowl Arena boasts 2,000 fixed seats and features an 8-sided digital scoreboard with 4 HD video screens. This arena includes a press box, running track and 4 large dressing rooms plus one referee room.

360° View: [Click Here](#)



POND ARENA

The Pond Arena, which has ice all year round, has seating for 400 including a wheelchair-accessible viewing area. This arena includes six large dressing rooms plus two referee rooms.

360° View: [Click Here](#)



ROTARY SPORTS & PERFORMANCE HALL (GYMNASIUM)



This large double gym has space for three volleyball courts or two basketball nets. The gym can be divided in half or quarters. Windows on two walls allow for ample natural daylight and automatic blinds can provide the darkness needed for presentations.

Size: 130' x 101'

Maximum Capacity: 700 people

360° View: [Click Here](#)

Room includes:

- Wireless Internet
- 6' Rectangular Tables
- Chairs

CAMECO MULTI-PURPOSE ROOMS

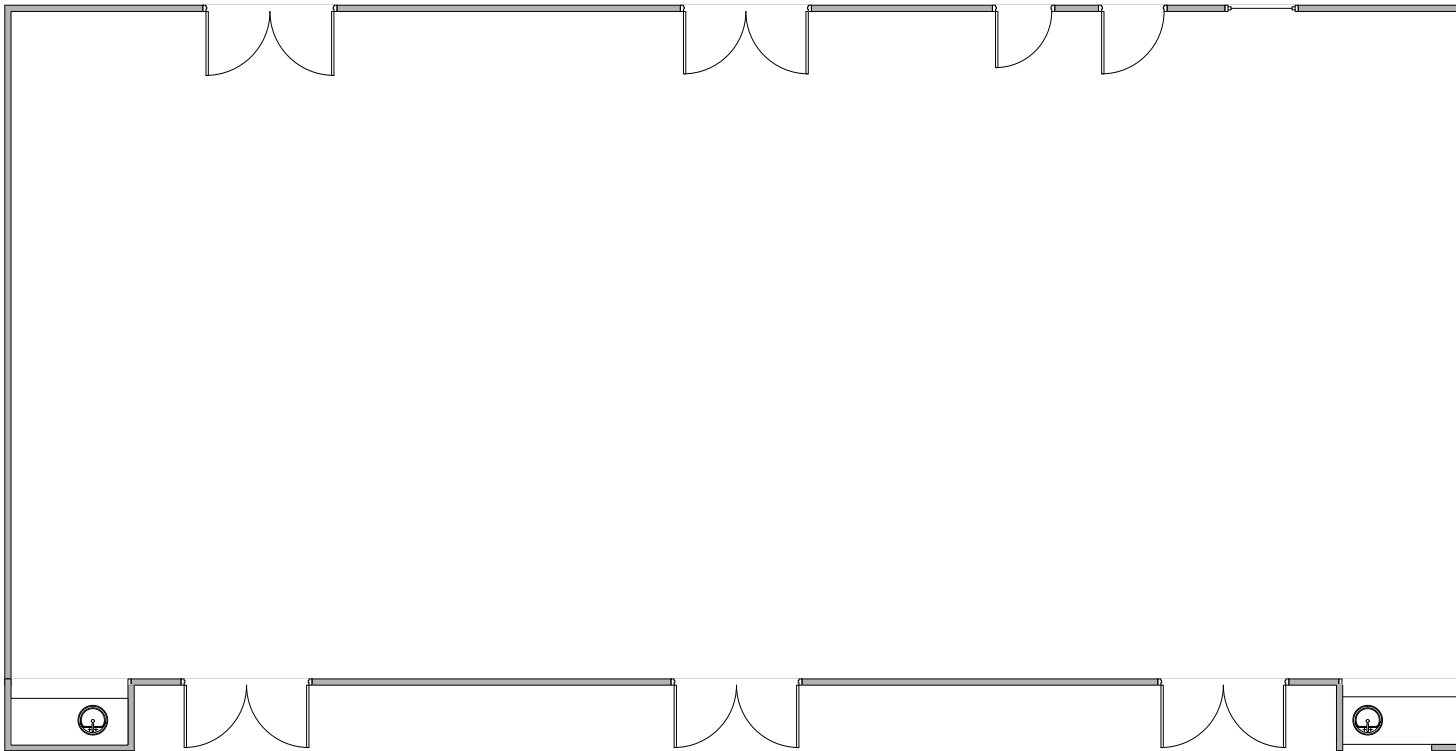

This large room can be divided into three separate rooms for added flexibility and features a semi-sprung floor, ideal for fitness programs.

Size: 75' x 34.5'

Max. Capacity:
100 people

360° View:
[Click Here](#)

Room Includes:

- Mirror along one wall
- Two ceiling mounted projectors
- Two sinks
- Access to kitchen (extra fee applies)
- 6' Rectangular Tables
- Chairs

HTM INSURANCE ROOM

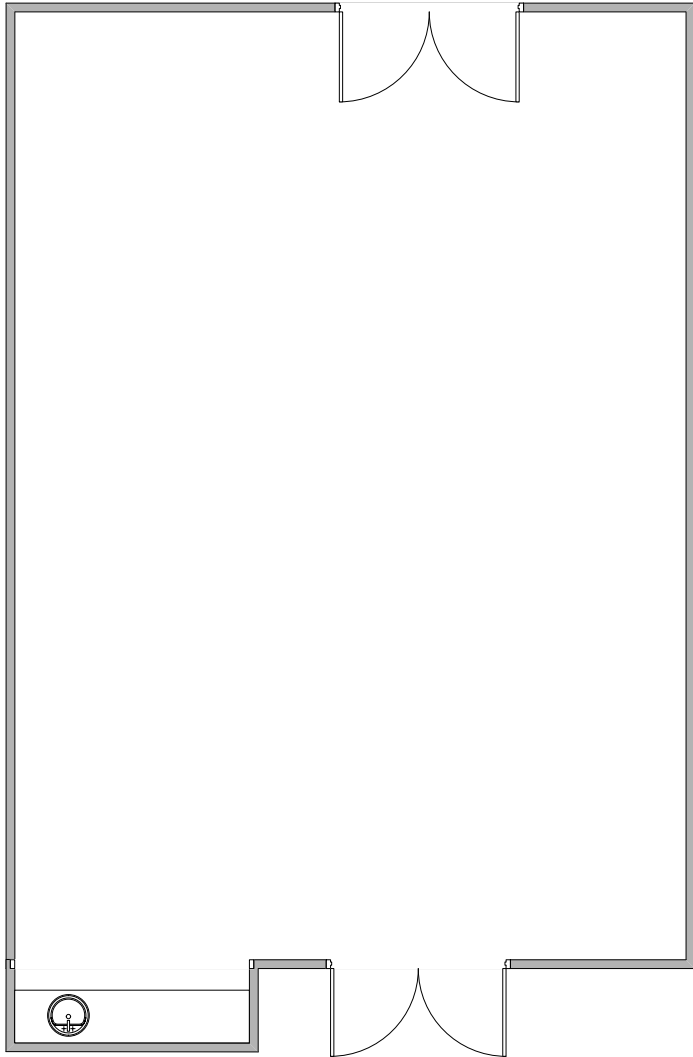

Located on the main floor this multi-purpose room has the flexibility to suit a variety of meetings & seminars.

Size: 25' x 34.5'

Maximum Capacity: 50 people (theatre-style)

360° View: [Click Here](#)

Room includes:

- Wireless Internet
- Bar fridge
- Sink
- 6' Rectangular Tables
- Chairs



SPOOLON YOUTH ROOM

Located on the main floor this multi-purpose room is ideal for medium-sized meetings and birthday parties.

Size: 25' x 34.5'

Maximum Capacity: 50 people (theatre-style)

Room includes:

- Wireless Internet
- 6' Rectangular Tables
- Chairs

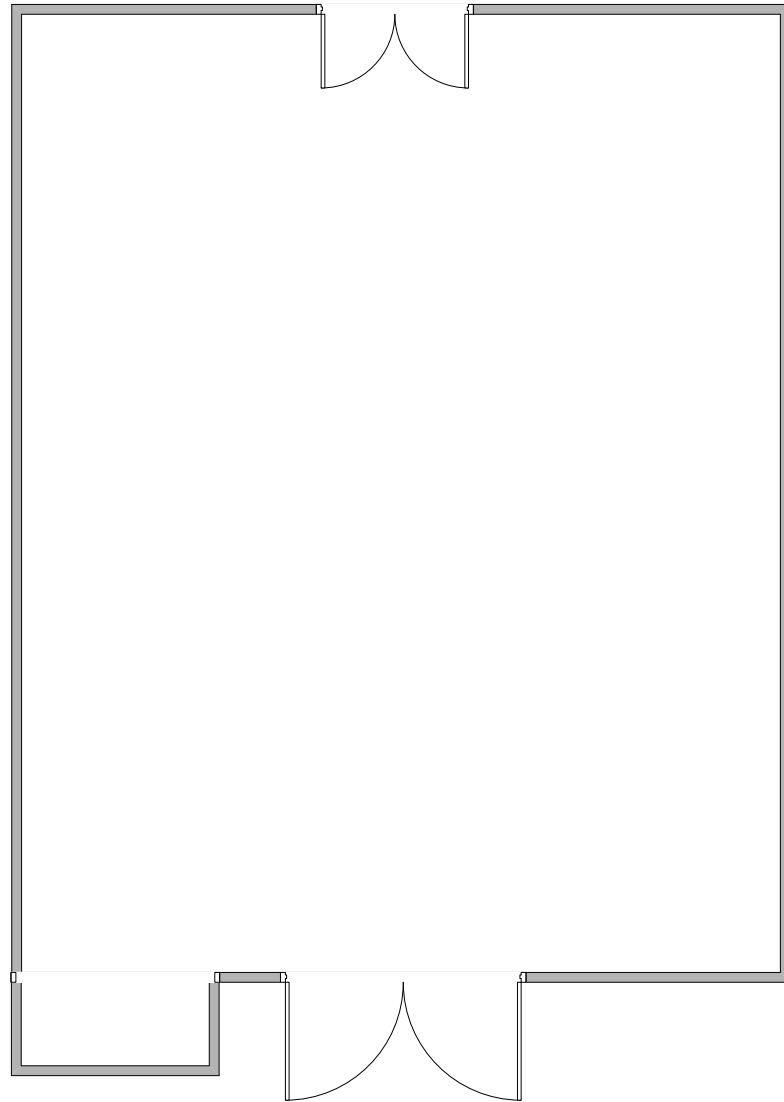



WHITELAW BOARDROOM

This executive boardroom will suit the needs of any intimate meeting.

Size: 27' x 19'

Maximum Capacity: 14 people

Room includes:

- Wireless Internet
- Ceiling mounted projector
- Wall mounted screen
- Wall mounted whiteboard
- Sink
- Bar Fridge
- Teleconference equipment
- Large boardroom table
- Chairs

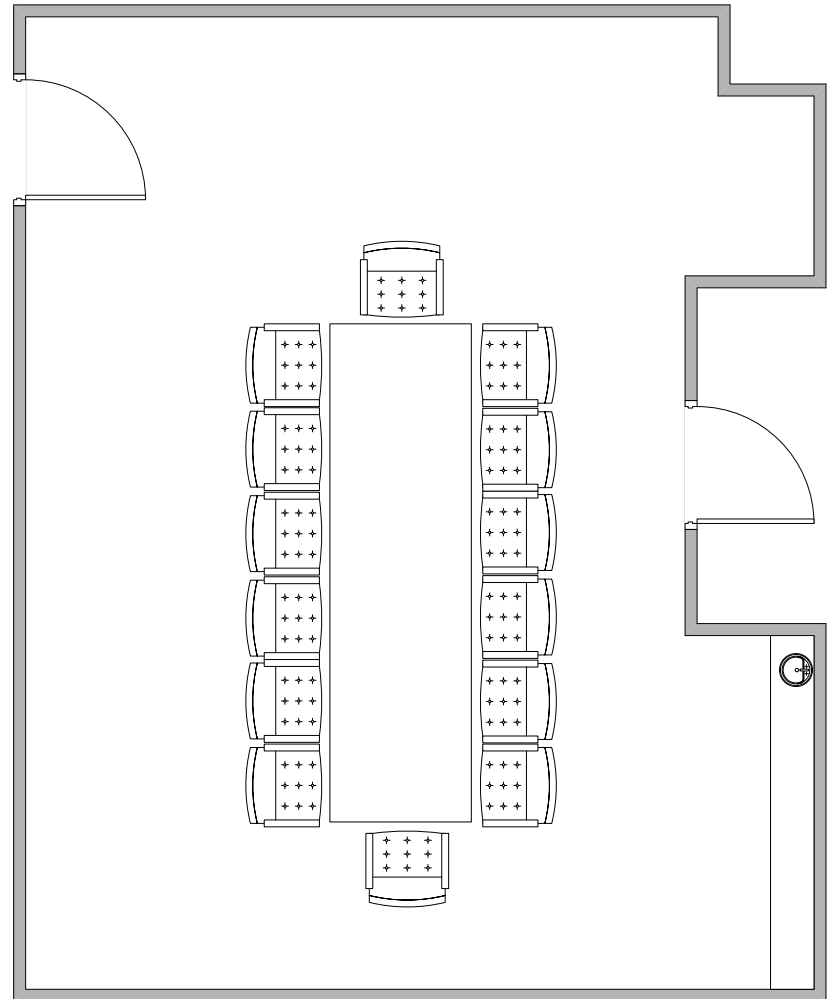



TOURNAMENT ROOM

This room is located on the second floor between the two ice pads and is a perfect spot for tournament headquarters.

Size: 50' x 10.5'

Maximum Capacity: 30

Room includes:

- Wireless Internet
- 6' Rectangular Tables
- Chairs

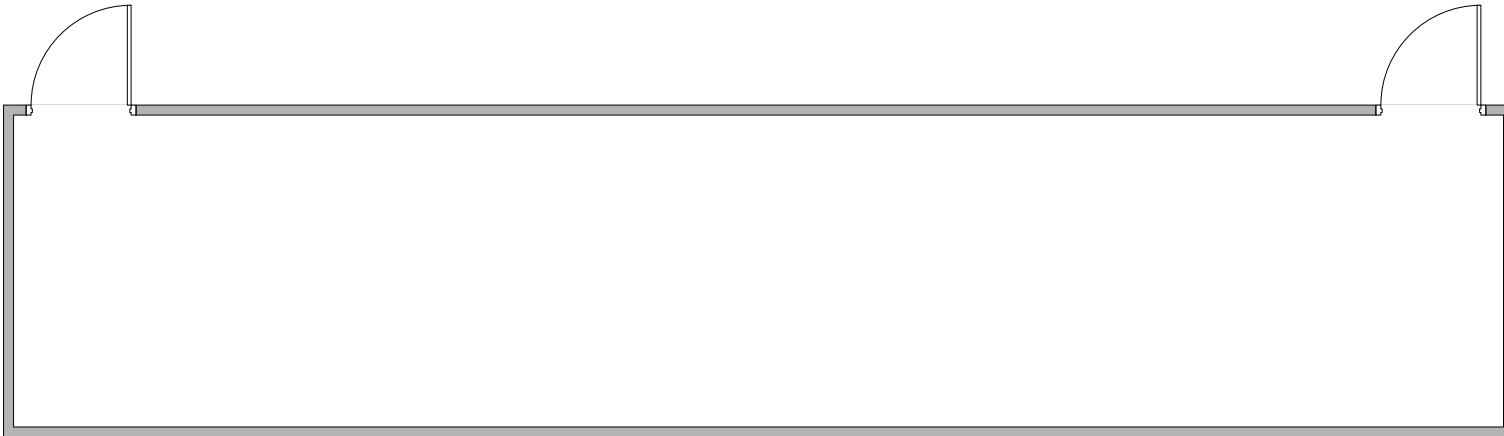

GRAND HALL

This large, open space is great for a reception or vendor showcases.

Size: 78' x 51'

Maximum Capacity: 100 people

360° View: [Click Here](#)

Room includes:

- Wireless Internet
- Lounge furniture
- 6' Rectangular Tables
- Chairs



ROOM CAPACITIES

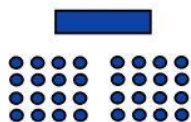

Theatre style

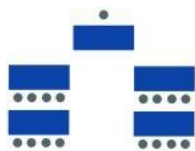

Classroom

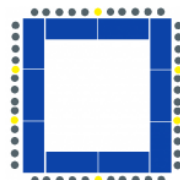

Open Square

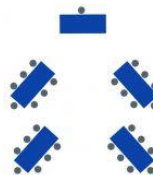

Pods

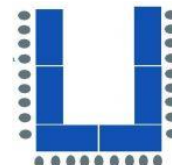

U-Shaped

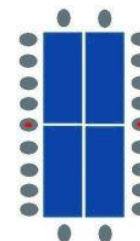

Boardroom

Room	Dimensions (Ft) L x W x H	Area (Sq. Ft.)	Capacity							
			Reception	Theatre	Classroom	Open Square	Pods	U-Shape	Boardroom	Banquet**
Whitelaw Room	27 x 19 x 9	513	-	-	-	-	-	-	14	-
Tournament Room	50 x 10.5 x 9	525	30	25	18	-	-	-	30	30
HTM Insurance Room & Spoolon Youth Room	25 x 34.5 x 9	863	60	50	27	36	30	24	24	60
Cameco Room A, B or C	25 x 34.5 x 9	863	60	50	27	36	30	24	24	60
Cameco Room A & B	50 x 34.5 x 9	1,725	100	100	54	48	60	45	30	80
Cameco Room A, B & C	75 x 34.5 x 9	2,588	100	100	72	66	90	53	-	100
Rotary Hall A or B (Gym)	101 x 65 x 30	6,565	280	280	*	*	*	*	-	200
Rotary Hall A & B (Gym)	101 x 130 x 30	13,130	700	700	*	-	*	-	-	400

*Contact CCC staff for more information.

**For Banquet set-up tables must be end-to-end.

AV AND OTHER EQUIPMENT

Available upon request:

- Wireless microphone
- Projector
- Projector Screen
- Audio cable
- Podium
- Sound system
- Lighting System
- Stage
- Pipe & Drape
- Kitchen Access

*Additional fees may apply. Equipment use is based on availability